

YORK HOUSE

78 QUEEN VICTORIA ST, EC4



GRYPHON
PROPERTY PARTNERS



DESCRIPTION

York House is a highly prominent Grade II listed building. The 2nd floor is available and provides approximately 1,000 sq ft of office accommodation and it benefits from excellent natural light on most elevations.

ACCOMMODATION

FLOOR

2nd

AREA

1,048 sq ft

TOTAL

1,048 sq ft

Floor area subject to measurement

LOCATION

York House is situated on Queen Victoria Street in the heart of the City of London, only a stones throw away from Mansion House Station and a short walk to Cannon Street, Bank and St Paul's stations.

SPECIFICATION/AMENITIES

- Fully fitted (2nd floor)
- Newly refurbished common parts
- 2 meetings rooms
- Kitchen
- Excellent natural light
- Air conditioning
- Passenger lift
- EPC - D82

YORK HOUSE

78 QUEEN VICTORIA ST, EC4



GRYPHON
PROPERTY PARTNERS

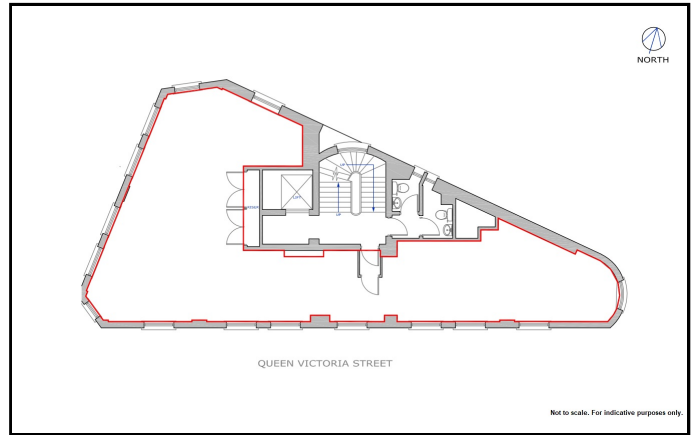

TERMS

LEASE

Flexible by arrangement

RENT

£52.50 per sq ft p.a.x.

RATES

£21.07 per sq ft (2019/20 est.)

SERVICE CHARGE

£18.19 per sq ft (est.)

VAT

Elected

VIEWING

Viewing strictly by prior appointment with the sole agent:

COLIN HARGREAVES

0203 440 9804

colin.hargreaves@gryphonpropertypartners.com

JAMIE MAJOR

0203 440 9809

jamie.major@gryphonpropertypartners.com

Subject to Contract

Gryphon Property Partners for themselves and for the vendors or lessors of this property whose agents they are, give notice that:- a. the particulars are set out as a general outline only for guidance and do not constitute, nor constitute part of, an offer or contract; b. all descriptions, dimensions, references to condition and necessary permissions for use and occupation, and other details are believed to be correct, but any intending purchasers, tenants or third parties should not rely on them as statements or representations of fact but satisfy themselves that they are correct by inspection or otherwise; c. All properties are measured in accordance with the RICS property measurement, 1st Edition May 2015 (incorporating IPMS) unless designated NIA/GIA/GEA, in which case properties are measured in accordance with the RICS Code of Measuring Practice (6th Edition); d. Any images may be computer generated. Any photographs show only certain parts of the property as they appeared at the time they were taken. August 2019